

## DIN 463 Specifications

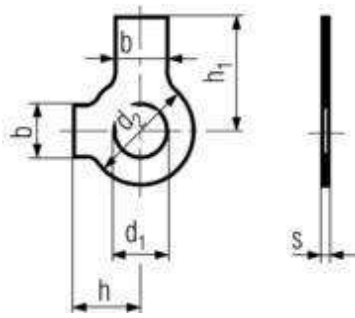

All measurements in millimeters (mm)

| $d_1$ | used for | $d_2$ | $h_1$ | $h$ | $b$ | $s$  |
|-------|----------|-------|-------|-----|-----|------|
| 3.2   | M3       | 7     | 13    | 5   | 4   | 0.38 |
| 4.3   | M4       | 9     | 14    | 6.5 | 5   | 0.38 |
| 5.3   | M5       | 10    | 16    | 8   | 6   | 0.5  |
| 6.4   | M6       | 12.5  | 18    | 9   | 7   | 0.5  |
| 8.4   | M8       | 17    | 20    | 11  | 8   | 0.75 |
| 10.5  | M10      | 21    | 22    | 13  | 10  | 0.75 |
| 13    | M12      | 24    | 28    | 15  | 12  | 1    |
| 15    | M14      | 28    | 28    | 16  | 12  | 1    |
| 17    | M16      | 30    | 32    | 18  | 15  | 1    |
| 21    | M20      | 37    | 36    | 21  | 18  | 1    |
| 25    | M24      | 44    | 42    | 25  | 20  | 1    |
| 28    | M27      | 50    | 48    | 29  | 23  | 1.6  |
| 31    | M30      | 56    | 52    | 32  | 26  | 1.6  |
| 34    | M33      | 60    | 56    | 34  | 28  | 1.6  |
| 37    | M36      | 66    | 60    | 38  | 30  | 1.6  |

All information is strictly informative